

mod.

# CPR-M3-I

Getto singolo quadrante bagnato predisposto per moduli induttivi  
Single jet wet dial pre-equipped for inductive modules



kiwa  
IT-TD-Kf0413  
KP-09071



Disponibile versione  
acqua calda 30-90°C

Available version  
for hot water 30-90°C

## ITA

Getto singolo, quadrante bagnato, lettura diretta. Dotato di anello anti-frode con coperchio girevole a 360°. Realizzato nelle versioni per acqua fredda e acqua calda nei calibri DN15 e DN20 mm (1/2"-3/4").

Predisposizione induttiva per l'installazione di moduli di trasmissione dati M-BUS cablati, wireless M-BUS, lancia impulsi di tipo amagnetico e LoRa.

## ENG

Single jet, wet dial, direct reading with anti-fraud ring with 360° rotating lid. Produced in the versions for cold water and hot water in the diameters DN15 and DN20 mm (1/2"- 3/4").

Inductive pre-equipment for the installation of data communication modules M-BUS wired and wireless M-BUS, non-magnetic pulse output and LoRa.

## ESP

Chorro único, esfera húmeda, lectura directa. Equipado de anillo antifraude con tapa, orientable a 360°. Producido en las versiones para agua fría y caliente en los calibres DN15 y DN20 mm (1/2"- 3/4").

Predisposición inductiva para módulos de telemetría M-BUS cable y wireless M-BUS, de pulsos amagnético y LoRa.

## FRA

Jet unique, cadran noyé à lecture directe. Equipé d'une bague d'invulnérabilité avec couvercle, orientable à 360°. Disponible en la version pour eau froide ou eau chaude en 2 calibres DN15 ou DN20 mm (1/2" ou 3/4").

Pre-équipement inductif pour modules de télérelèvement M-BUS filaire et radio M-BUS, avec émetteur d'impulsions amagnétique et LoRa.

Moduli compatibili  
Compatible modules

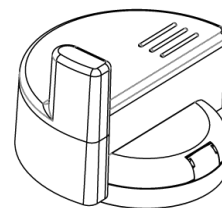

mod. **IWM-LR3**

**LoRaWAN**

mod. **IWM-TX3**

**M-Bus**  
wireless

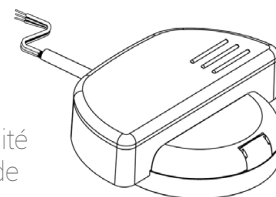

mod. **IWM-MB3**

**M-Bus**

mod. **IWM-PL3**

**PULSE**

Calibro Size		DN (inch)	15 (1/2")	20 (3/4")
	Portata di sovraccarico Overload flow rate	Q <sub>4</sub>	m <sup>3</sup> /h	3,12    5
	Portata permanente Permanent flow rate	Q <sub>3</sub>	m <sup>3</sup> /h	2,5    4
R=100 VH ↑	Portata di transizione Transitional flow rate	Q <sub>2</sub>	L/h	40    64
	Portata minima Min flow rate	Q <sub>1</sub>	L/h	25    40
R=160 H ↑	Portata di transizione Transitional flow rate	Q <sub>2</sub>	L/h	25    40
	Portata minima Min flow rate	Q <sub>1</sub>	L/h	15,63    25
Lettura minima Min reading		L	0,05	
Lettura massima Max reading		m <sup>3</sup>	99.999	
Pressione max ammissibile Max admissible pressure MAP		bar	16	

**Versione base - Basic version**

- R100-VH ↑ →
- Disponibile in versione per acqua fredda 0,1°C-50°C e per acqua calda 30°C-90°C
- Trasmissione meccanica
- Lettura diretta su 5 rulli numeratori
- Quadrante bagnato
- Coperchio girevole a 360°

- R100-VH ↑ →
- Available for cold water 0,1°C-50°C and for hot water 30°C-90°C
- Mechanical transmission
- Direct reading on 5 numeric rolls
- Wet dial
- 360° rotating lid

**Su richiesta - Upon request**

- Versione R160-H ↑ R100-VH →

- Version R160-H ↑ R100-VH →

**Posizione d'installazione - Installation position**

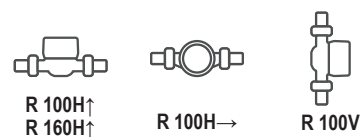

Coperchio  
Lid



Anello di chiusura antifrode  
Anti-fraud 360° rotatable ring

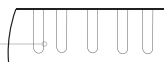

Anello di chiusura  
Brass sealing ring

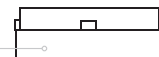

Vetro plastico  
Plastic glass



Anello fermaorologio  
Plastic ring

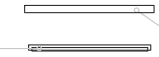

Turbina  
Turbine

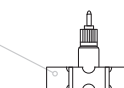

Guarnizioni di scorrimento  
Sliding gasket



Guarnizioni  
Gasket



Orologeria  
Totalising mechanism

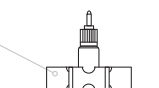

Perno di base  
Pivot



Filtro  
Strainer



Cassa ottone  
Brass body

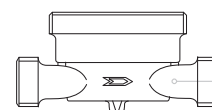

**Dimensioni e pesi - Dimensions and Weights**

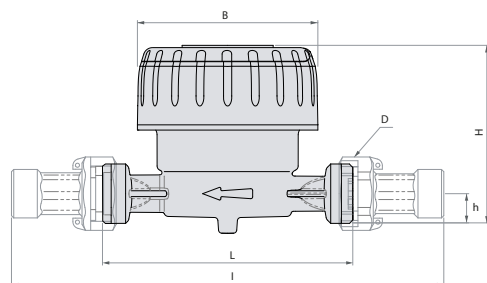

Calibro Size	DN (inch)	15 (1/2")	20 (3/4")
L	mm	110	130
I	mm	190	228
H	mm	77	81
h	mm	13	17
B	mm	80	80
D	Filettatura Threading	in	3/4"    1"
Pesi Weight	con raccordi with unions	Kg	0,76    0,93
	senza raccordi without unions	Kg	0,62    0,69

Filettatura - Threading EN ISO 228-1:2003